

Preliminary TDA GRANT APPLICATION

**Taylor Boulevard Sidewalk
Installation Project
FY2026/2027**



100 Gregory Lane
Pleasant Hill, CA 94523
Ph: 925-671-5264
www.phillca.gov



Attachment B**TDA Article 3 Project Application Form**

1. Agency	City of Pleasant Hill		
2. Primary Contact	Laetitia Galeazzi, PE, Senior Civil Engineer		
3. Mailing Address	100 Gregory Lane, Pleasant Hill, CA 94523		
4. Email Address	lgaleazzi@philca.gov	5. Phone Number	925-671-5252
6. Secondary Contact (in the event primary is not available)	Anthony Nuti, PE, Associate Engineer		
7. Mailing address (if different) N/A <input checked="" type="checkbox"/>			
8. Email Address	anutu@philca.gov	9. Phone Number	925-671-5203
10. Send allocation instructions to (if different from above):			
11. Project Title	Taylor Boulevard Sidewalk Installation Project		
12. Amount requested	\$250,000	13. Fiscal Year of Claim	2026/2027

14. Description of Overall Project:

For the 2022/2023 fiscal year, the City of Pleasant Hill applied and won TDA funding to construct 900 feet of ADA-compliant pathway of travel along Taylor Boulevard between Civic Drive and Ruth Drive. The proposed Taylor Boulevard Sidewalk Installation Project (Project) will close the final gap along Taylor Boulevard and replace approximately 850 feet of existing non-compliant asphalt path located on the south side of Taylor Boulevard between Lucille Lane/Norse Drive and Civic Drive with a new 6' concrete sidewalk. This project will also upgrade the existing non-compliant ADA curb ramps at the southeast corner of the intersection of Taylor Boulevard and Lucille Lane/Norse Drive and at the southwest corner of the intersection of Taylor Boulevard and Civic Drive, rehabilitate the existing east crosswalk at the intersection of Taylor Boulevard and Lucille Lane/Norse Drive, and rehabilitate the striping and markings of the eastbound bike lane along Taylor Boulevard. See attached plan set for more details on the extent of this Project.

This improvement will connect residents to the various schools in the area (e.g. Gregory Gardens Elementary School, Valley View Middle School, College Park High School, and Diablo Valley College), the YMCA, Police Department, Community Center, and various businesses. Taylor Boulevard is a busy principal arterial in the City of Pleasant Hill with a traffic volume of 16,000 vehicles per day. Residents and pedestrians are reluctant to utilize Taylor Boulevard as a safe path of travel due to motorized traffic. The proposed sidewalk is needed to provide students, residents, and bicyclists a safe means of access. The proposed project will encourage walking/biking to school and other civic destinations from the surrounding neighborhoods.

15. **Project Scope Proposed for Funding:** (Project level environmental, preliminary planning, and ROW are ineligible uses of TDA funds.)

The proposed TDA funds will be applied towards construction of the improvements as listed on the attached detailed estimate.

16. **Project Location:** A map of the project location is attached or a link to an online map of the project location is provided below:

Project location map attached.

Project Relation to Regional Policies (for information only)

17. Is the project in an [Equity Priority Community](#)? Yes ☐ No ☒

18. Is this project in a [Priority Development Area](#) or a [Transit-Oriented Community](#)? Yes ☐ No ☒

19. **Project Budget and Schedule**

Project Phase	TDA 3	Other Funds	Total Cost	Estimated Completion (month/year)
Bike/Ped Plan				
ENV				
PA&ED				
PS&E				
ROW				
CON	\$ 250,000.00	\$ 161,996.00	\$ 411,996.00	July 2027
Total Cost	\$ 250,000.00	\$ 161,996.00	\$ 411,996.00	

Project Eligibility

A. Has the project been reviewed by the Bicycle and Pedestrian Advisory Committee? Yes ☐ No ☒
If "YES," identify the date and provide a copy or link to the agenda.
If "NO," provide an explanation). Explanation: Submitting for Review

B. Has the project been approved by the claimant's governing body? Yes ☒ No ☐
If "NO," provide expected date: _____

C. Has this project previously received TDA Article 3 funding? Yes ☐ No ☒
(If "YES," provide an explanation on a separate page)

D. For "bikeways," does the project meet Caltrans minimum safety design criteria pursuant to [Chapter 1000 of the California Highway Design Manual](#)? Yes ☒ No ☐

E. 1. Is the project categorically exempt from CEQA, pursuant to CCR Section 15301(c), Existing Facility? Yes ☒ No ☐

2. If "NO" above, is the project is exempt from CEQA for another reason? Yes ☐ No ☐
Cite the basis for the exemption. N/A
If the project is not exempt, please check "NO," and provide environmental documentation, as appropriate.

F. Estimated Completion Date of project (month and year): July 2027

G. Have provisions been made by the claimant to maintain the project or facility, or has the claimant arranged for such maintenance by another agency? (If an agency other than the Claimant is to maintain the facility, please identify below and provide the agreement. Yes ☒ No ☐

H. Is a Complete Streets Checklist required for this project? Yes ☐ No ☒
If the amount requested is over \$250,000 or if the total project phase or construction phase is over \$250,000, a Complete Streets checklist is likely required. Please attach the Complete Streets checklist or record of review, as applicable. More information and the form may be found here: <https://mtc.ca.gov/planning/transportation/complete-streets>

MAPS

Regional Map
Project Locations
School Area Map

Regional Map



Project Location

LEGEND

 Sonoma	 Solano	 San Francisco
 Napa	 Contra Costa	 San Mateo
 Marin	 Alameda	 Santa Clara

 BART	 Caltrain
 Capitol Corridor	 San Joaquin (Amtrak)
 ACE (Altamont Commuter Express)	

DA MASTER/AV MULTIMEDIA SERVICES DEPT 100100

City of Pleasant Hill, Contra Costa County, California
Vicinity Map

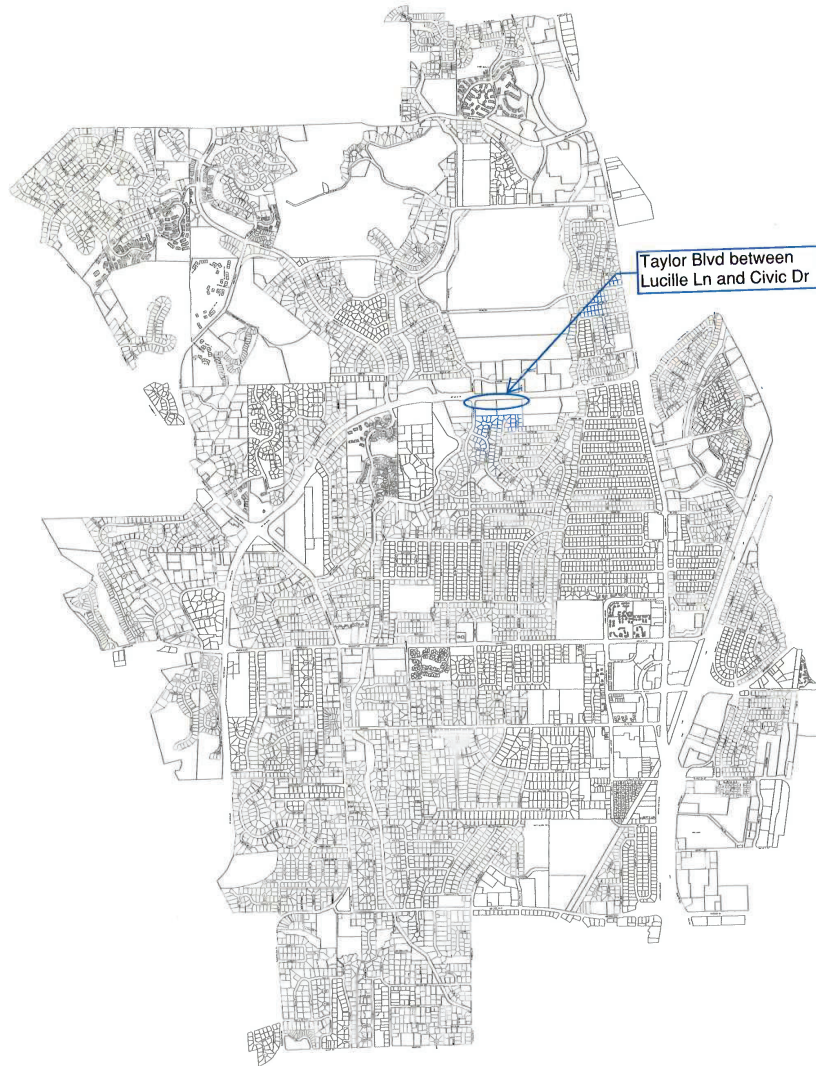

0 750 1,500 3,000 4,500 6,000 Feet





Taylor Boulevard Sidewalk Installation Project
Project Location Map

SITE PHOTOS

Taylor Boulevard Asphalt Path



End of Sidewalk at Civic Drive Intersection



End of Shared Path at Lucille Lane



ESTIMATE

City of Pleasant Hill
100% Draft Estimate of Probable Construction Cost
Taylor Blvd Sidewalk Installation Project
July 31, 2025

Item	Item Description	Unit	Quantity	Unit Price	Item Total
1	Mobilization	LS	1	\$ 23,600.00	\$ 23,600.00
2	Clearing, Grubbing, and Tree Protection	LS	1	\$ 10,200.00	\$ 10,200.00
3	Traffic/Pedestrian Control System and Construction Area Signs	LS	1	\$ 20,300.00	\$ 20,300.00
4	Portable Changeable Message Sign	EA	1	\$ 3,000.00	\$ 3,000.00
5	Construction Layout and Staking	LS	1	\$ 6,800.00	\$ 6,800.00
6	Water Pollution Control	LS	1	\$ 3,400.00	\$ 3,400.00
7	Contractor Supplied Biologist	LS	1	\$ 5,000.00	\$ 5,000.00
8	Contractor Supplied Arborist	LS	1	\$ 3,000.00	\$ 3,000.00
9	Remove Concrete	SF	368	\$ 25.00	\$ 9,200.00
10	Remove AC Pathway Pavement (4")	SF	4,003	\$ 10.00	\$ 40,030.00
11	Remove Roadway AC/AB (6")	SF	558	\$ 12.00	\$ 6,696.00
12	Remove Thermoplastic Striping and Markings	LS	1	\$ 1,300.00	\$ 1,300.00
13	Remove Tree	EA	1	\$ 5,000.00	\$ 5,000.00
14	Earthwork Removal	CY	51	\$ 260.00	\$ 13,130.00
15	Chemical Root Barrier	LF	300	\$ 15.00	\$ 4,500.00
16	Concrete Curb Ramp	EA	2	\$ 9,000.00	\$ 18,000.00
17	Concrete Sidewalk	SF	286	\$ 25.00	\$ 7,150.00
18	Concrete Sidewalk with Thickened Edge	SF	4,955	\$ 40.00	\$ 198,200.00
19	Concrete Curb and Gutter	LF	57	\$ 100.00	\$ 5,700.00
20	HMA Type A Conform	SF	335	\$ 10.00	\$ 3,350.00
21	Thermoplastic Basic Crosswalk (12")	LF	96	\$ 15.00	\$ 1,440.00
22	Thermoplastic Bike Lane Line	LF	720	\$ 8.00	\$ 5,760.00
23	Thermoplastic Pavement Markings	SF	11	\$ 20.00	\$ 220.00
24	Import Soil for Widened Lawn (Clean Fill)	CY	16	\$ 100.00	\$ 1,600.00
25	Sod Conform to Path and Existing Lawn	SF	742	\$ 10.00	\$ 7,420.00
26	Irrigation Adjustment	LS	1	\$ 8,000.00	\$ 8,000.00
				Base Bid Total	\$ 411,996.00
Additive Bid Item					
1A	Tree Pruning - 14 Trees	LS	1	\$ 3,000.00	\$ 3,000.00
				Additive Bid Total	\$ 3,000.00

**CEQA NOTICE
OF EXEMPTION**

Notice of Exemption

Appendix E

To: Office of Planning and Research
P.O. Box 3044, Room 113
Sacramento, CA 95812-3044

From: (Public Agency): City of Pleasant Hill

100 Gregory Lane

Pleasant Hill CA 94523

County Clerk

County of: Contra Costa

555 Escobar Street

Martinez, CA 94553

(Address)

Project Title: Taylor Boulevard Sidewalk Installation Project

Project Applicant: City of Pleasant Hill

Project Location - Specific:

South side of Taylor Boulevard, between Lucille Lane and Civic Drive

Project Location - City: Pleasant Hill

Project Location - County: Contra Costa

Description of Nature, Purpose and Beneficiaries of Project:

The proposed project would replace the existing 4' to 6' wide asphalt roadway pavement path on the south side of Taylor Boulevard between Lucille Lane and Civic Drive with a 6' wide concrete path. The replacement pathway will require minor grading and conform to the existing base with new soil. Additional improvements include reducing the corner radius at the southeast corner of Taylor Boulevard and Lucille Lane to place an ADA compliant bi-directional curb ramp to serve the pedestrian crossing to the north and to the south. Additional improvements include widening the existing sidewalk on Taylor Boulevard between Lucille Lane and Civic Drive, adding ADA compliant curb ramps at the intersections of Taylor Boulevard and Lucille Lane, and Taylor Boulevard and Civic Drive. New construction will include new ADA compliant curb ramps, concrete sidewalks, curb and gutter, and landscape containers, import soil, trees, shrubs, and mulch. Existing trees, shrubs, and mulch will be removed and replaced with new trees, shrubs, and mulch. The approximate maximum depth of excavation to grade the new pathway and improvements is approximately 2 feet. Project construction permits have been adopted to protect biological resources and including tree removal will take place outside of nesting bird season (15th February to 31st August). If tree removal takes place during nesting bird season, a biologist will conduct a nesting bird survey in the 7 days prior to removal. If active nests are found, a no-work buffer surrounding the nest will be determined in consultation with CDFW. The no-work buffer will remain in place until the biologist has confirmed the young are hatching independently or the nest has failed, and if no work will be continued within the existing permit area and existing landscape areas.

Name of Public Agency Approving Project: City of Pleasant Hill

Name of Person or Agency Carrying Out Project: City of Pleasant Hill

Exempt Status: (check one):

- ☐ Ministerial (Sec. 21080(b)(1); 15268);
- ☐ Declared Emergency (Sec. 21080(b)(3); 15269(a));
- ☐ Emergency Project (Sec. 21080(b)(4); 15269(b)(c));
- ☒ Categorical Exemption. State type and section number: 15301 and 15304
- ☐ Statutory Exemptions. State code number: _____

Reasons why project is exempt:

The proposed project would improve pedestrian accessibility and safety by replacing a narrow asphalt path with a wider concrete sidewalk and installing ADA-compliant curb ramps at key intersections with a max. excavation of 2 feet. All improvements enhance existing facilities within existing City right-of-way with no new lanes or increase in capacity. No hazards or scenic resources would be impacted. The project would include the implementation of construction controls to avoid migratory birds protected under the Migratory Bird Treaty Act and to ensure that unanticipated cultural resources discovered on site during construction are protected. Therefore, the project will not result in any adverse effects, and there are no exceptions to the exemption.

Lead Agency

Contact Person: Laetitia Galeazzi Area Code/Telephone/Extension: 1-925-671-5252

If filed by applicant:

1. Attach certified document of exemption finding.
2. Has a Notice of Exemption been filed by the public agency approving the project? Yes No

Signature: [Signature] Date: 11/18/25 Title: City Planner

Signed by Lead Agency Signed by Applicant

Authority cited: Sections 21083 and 21110, Public Resources Code.
Reference: Sections 21108, 21152, and 21152.1, Public Resources Code.

Date Received for filing at OPR: _____

PRELIMINARY PLANS

CITY OF PLEASANT HILL TAYLOR BOULEVARD SIDEWALK INSTALLATION PROJECT

NCE
1003 W. Cutting Blvd., Suite 110
Point Richmond, CA 94804
(510) 215-3620 • Fax (510) 215-2898



**TAYLOR BLVD
SIDEWALK
INSTALLATION
PROJECT**

OWNER



CITY OF PLEASANT HILL
CITY OF PLEASANT HILL
100 GREGORY LANE
PLEASANT HILL,
CALIFORNIA

NO.	DATE	DESCRIPTION

PROJECT NO: 484.18.55

DESIGNED BY: JV

DRAWN BY: IMA

CHECKED BY: FH DATE: 7/21/2025

DATE: 7/31/2025

This drawing is the property of NCE, including all potential and patentable features, and/or confidential information, and its use is conditioned upon the user's agreement not to reproduce the drawing, in whole or part, for the material described therein, nor the use of the drawing for any purpose other than specifically permitted in writing by NCE.

SHEET TITLE

TITLE SHEET

DRAWING

G1

SHEET 1 OF 11

SHEET INDEX		
SHEET NO	DRAWING NO	SHEET TITLE
G1	1	TITLE SHEET
G2	2	NOTES LEGEND AND ABBREVIATIONS
C1	3	DEMOLITION PLAN TAYLOR BOULEVARD "T" 10+00 TO "T" 17+50
C2	4	DEMOLITION PLAN TAYLOR BOULEVARD "T" 17+50 TO "T" 18+75
C3	5	IMPROVEMENT PLAN TAYLOR BOULEVARD "T" 10+00 TO "T" 13+50
C4	6	IMPROVEMENT PLAN TAYLOR BOULEVARD "T" 13+50 TO "T" 17+50
C5	7	IMPROVEMENT PLAN TAYLOR BOULEVARD "T" 17+50 TO "T" 18+75
C6	8	CROSS SECTIONS
D1	9	DETAILS 1
D2	10	DETAILS 2
D3	11	CURB RAMP DETAILS

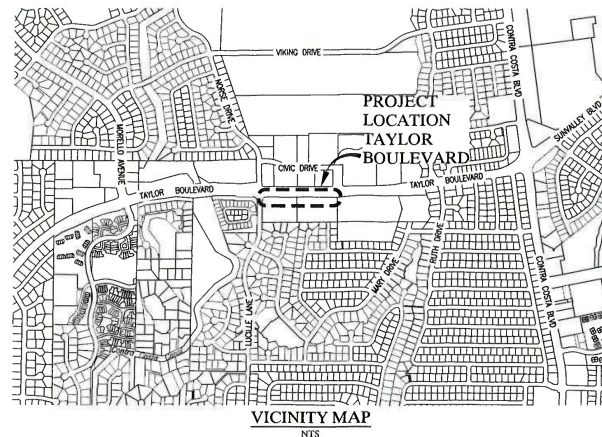
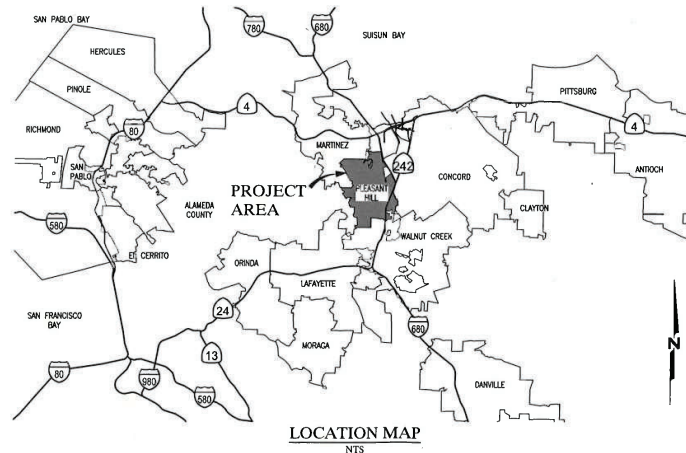

1003 West Cutting Boulevard, Suite 110
Pt. Richmond, CA 94804
(510) 215-3620

OWNER



City of Pleasant Hill
100 Gregory Lane
Pleasant Hill, Ca. 94523
Ph: (925) 671-5270

PREPARED UNDER
THE DIRECTION OF:

JENNIFER VAN DYKE, P.E.
ASSOCIATE ENGINEER, NCE

REVIEWED
BY:

FRANZ HADINGER, P.E.
PRINCIPAL, CHIEF ENGINEER, NCE

APPROVED
BY:

ANN JAMES
PUBLIC WORKS DIRECTOR/ACTING CITY ENGINEER

DATE: 7/31/2025

DATE: 7/31/2025

DATE: 7/31/2025

100% SUBMITTAL
PRELIMINARY
FOR REVIEW
NOT FOR CONSTRUCTION
DATE: 7/31/2025

811
Know what's below.
Call before you dig.



1. CONTRACTOR TO FIELD VERIFY THE LOCATION OF THE EXISTING INTERGRATOR SYSTEM AND ADJUST EXISTING VALVES, BRICKS AND SPRAY HEADS AS NECESSARY TO AVOID CONFLICTS WITH THE PROPOSED PATH TO MAINTAIN 100% COVERAGE OF THE EXISTING LAWN WITHIN THE WORK AREA, UNLESS OTHERWISE NOTED.
2. CONTRACTOR TO REPAIR DISTURBED AREAS OF LAWN.
3. SAWCUT CONCRETE AT NEAREST CONSTRUCTION JOINT.
4. ALL CONSTRUCTION WORK WITHIN 8 FEET OF TREES SHALL REQUIRE TREE PROTECTION. SEE 3/022
5. THE REMOVAL OF THE EXISTING AC PATH SHALL INCLUDE ADDITIONAL EXCAVATION AS NEEDED TO ACCOMMODATE 4" PCC OVER 4" AGGREGATE BASE.

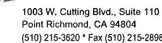

CITY OF PLEASANT HILL
CITY OF PLEASANT HILL
100 GREGORY LANE
PLEASANT HILL,
CALIFORNIA

PROJECT NO:	484.18.5
DESIGNED BY:	

DESIGNED BY: J
DRAWN BY: IM

This drawing is the property of HCE, including all patented and patentable features, and/or confidential information and

Its use is conditioned upon the user's agreement not to reproduce the drawing, in whole or part, nor the material described thereon, nor the use of the drawing for any purpose other than specifically permitted in writing by NCE.

SHEET TITLE

DEMOLITION PLAN

DEMOLITION PLAN
TAYLOR BOULEVARD

"T" 17+50 TO "T" 18+75

DRAWING C2

SHEET 4 OF 11

- 1 TRAFFIC SIGNAL POLE, PROTECT IN PLACE
- 2 TRAFFIC SIGNAL BOX, PROTECT IN PLACE
- 3 ELECTRICAL VAULT, PROTECT IN PLACE
- 5 TELECOM VAULT, PROTECT IN PLACE
- 9 WATER VALVE, PROTECT IN PLACE
- 10 UTILITY POLE, PROTECT IN PLACE
- 11 UTILITY MANHOLE, PROTECT IN PLACE

	CLEAR AND GRUB/EARTHWORK REMOVAL/GRADING
	REMOVE AC PAVEMENT
	REMOVE CONCRETE

 TREE TO REMAIN, PROTECT IN PLACE, SEE DETAIL 1/D2

REMOVE TREE

 STREET LIGHT TO REMAIN, PROTECT IN PLACE

UTILITY POLE, PROTECT IN PLACE

100% SUBMITTAL
PRELIMINARY
FOR REVIEW
NOT FOR CONSTRUCTION
DATE: 7/31/2025





1003 W. Cutting Blvd., Suite 110
Point Richmond, CA 94804
(510) 215-3620 • Fax (510) 215-2999



TAYLOR BLVD SIDEWALK INSTALLATION PROJECT

OWNER



CITY OF PLEASANT HILL
100 GREGORY LANE
PLEASANT HILL,
CALIFORNIA

NO. DATE DESCRIPTION

PROJECT NO. 484.18.55

DESIGNED BY: JV

DRAWN BY: IMA, AP

CHECKED BY: FH DATE 7/21/2025

DATE: 7/31/2025

This drawing is the property of NCE, including all patented and proprietary features, and/or confidential information and its use is conditional upon the user's agreement not to reproduce the drawing, in whole or in part, nor the material contained therein, nor use of the drawing for any purpose other than specifically permitted in writing by NCE.

SHEET TITLE

IMPROVEMENT PLAN
TAYLOR BOULEVARD
"T" 13+50 TO "T" 17+50

DRAWING

C4

SHEET 6 OF 11

NOTES:

- CONTRACTOR SHALL FIELD VERIFY THE LOCATION OF THE EXISTING IRRIGATION SYSTEM INCLUDING CONTROL VALVES, VALVE BOXES, AND SPRAY HEADS, AND SHALL ADJUST OR PROTECT IRRIGATION EQUIPMENT AS NECESSARY TO AVOID CONFLICTS WITH THE PROPOSED PEDESTRIAN PATHWAY. CONTRACTOR SHALL ENSURE 100% COVERAGE OF THE EXISTING LAWN WITHIN THE AREA OF IMPROVEMENTS, UNLESS OTHERWISE NOTED. CONTRACTOR TO NOTIFY ENGINEER IF CONFLICTS EXIST (TYP)

LEGEND:

- CONTRACTOR TO REPAIR AREAS OF LAWN IMPACTED BY IMPROVEMENTS WITH LAWN TO MATCH EXISTING
- EXISTING TREE TO REMAIN, PROTECT IN PLACE, SEE DETAIL 3/02

"T" ALIGNMENT TABLE

NUMBER	STATION	RADIUS	LENGTH	BEARING OR
L1	9+50.00	10.30	N11° 46' 29.58"E	
C1		30.00	N42° 13' 42.86"E	
L2	9+92.19	9.99	N72° 40' 55.76"E	
C2		100.00	N79° 55' 32.19"E	
L7	10+27.47	37.67	N87° 10' 08.62"E	
C9		120.00	N44° 56' 11' 37.46"E	
L8	11+09.69	25.63	S71° 33' 23.55"E	
C8		146.00	N57° 58' 22' 53.50"E	
L9	12+21.07	29.28	N74° 47' 36.54"E	
C3		173.00	N66° 19' 45' 18.07"E	
C4		173.00	N88° 23' 22.80"E	
L4	13+66.83	0.36	N80° 03' 46.01"E	
C5		440.00	N85° 09' 20.94"E	
L5	14+45.41	92.83	S89° 45' 04.13"E	
C6		1218.00	N35° 58' 33' 51.91"E	
L6	16+73.53	0.76	S83° 22' 39.89"E	
C7		345.00	N04° 57' 01.90"E	
L10	17+78.72	0.76	N79° 16' 43.48"E	
C10		371.00	N84° 36' 11.76"E	
L11	18+48.44	26.44	N89° 55' 40.04"E	

IMPROVEMENT KEYNOTES:

- TRAFFIC SIGNAL BOX, PROTECT IN PLACE
- ELECTRICAL VAULT, PROTECT IN PLACE
- TELECOM VAULT, PROTECT IN PLACE
- TELECOM BOX, PROTECT IN PLACE
- SIGN, PROTECT IN PLACE
- UTILITY POLE, PROTECT IN PLACE

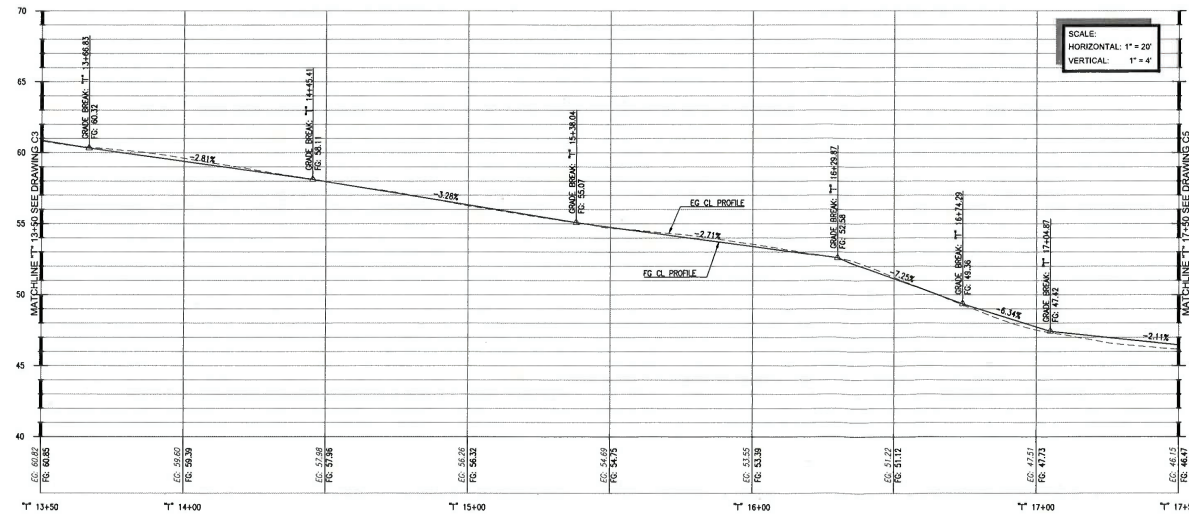
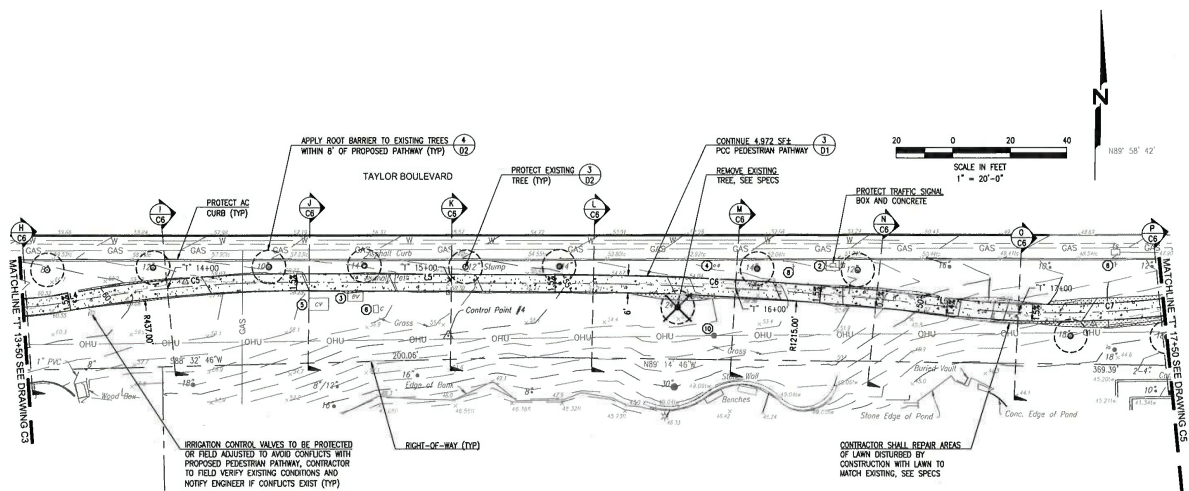

100% SUBMITTAL
PRELIMINARY
FOR REVIEW
NOT FOR CONSTRUCTION
DATE: 7/31/2025

811
Know what's below.
Call before you dig.

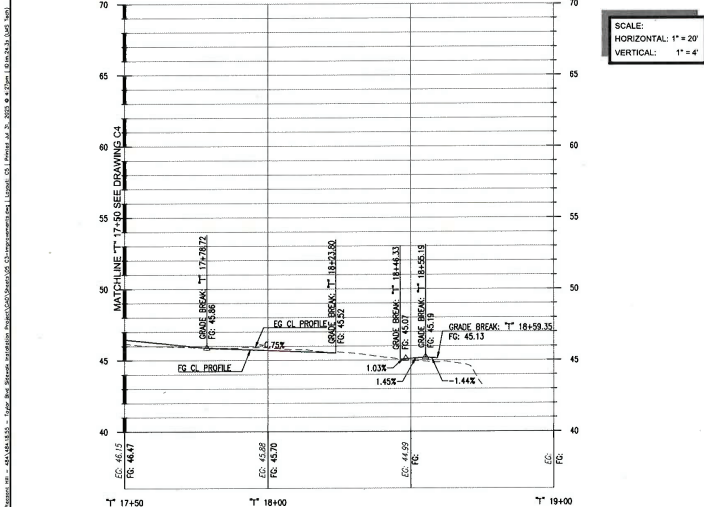

SHEET 7 OF 11



**Know what's below.
Call before you dig.**



**TAYLOR BLVD
SIDEWALK
INSTALLATION
PROJECT**



CITY OF PLEASANT HILL
100 GREGORY LANE
PLEASANT HILL,
CALIFORNIA

NO.	DATE	DESCRIPTION

PROJECT NO: 484.18.55
DESIGNED BY: JV
DRAWN BY: IMA
CHECKED BY: FH DATE: 7/21/2025
DATE: 7/31/2025

This drawing is the property of NCE, including all patented and proprietary features, and/or confidential information and its use is conditioned upon the user's agreement not to reproduce the drawing, in whole or in part, nor the material contained therein, nor the use of the drawing for any purpose other than specifically permitted in writing by NCE.

SHEET TITLE

DETAIL 1

DRAWING

D1

SHEET 9 OF 11

811
Know what's below.
Call before you dig.
100% SUBMITTAL
PRELIMINARY
FOR REVIEW
NOT FOR CONSTRUCTION
DATE: 7/31/2025

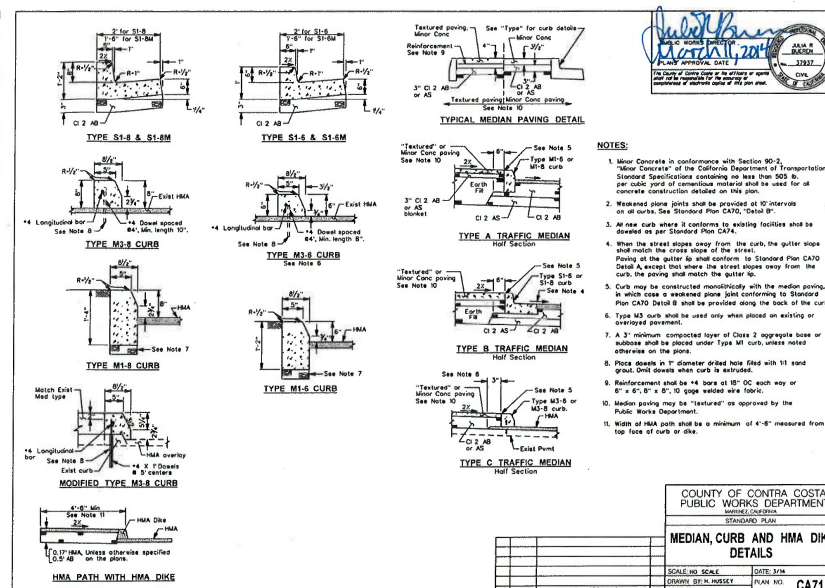
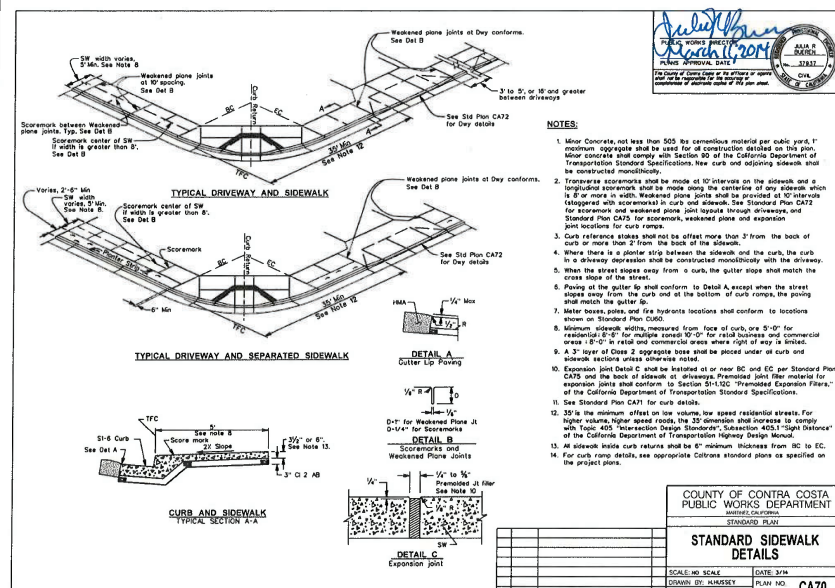

1 SIDEWALK CONSTRUCTION DETAILS
D1 NTS

2 STANDARD CURB AND HMA DETAILS
D1 NTS

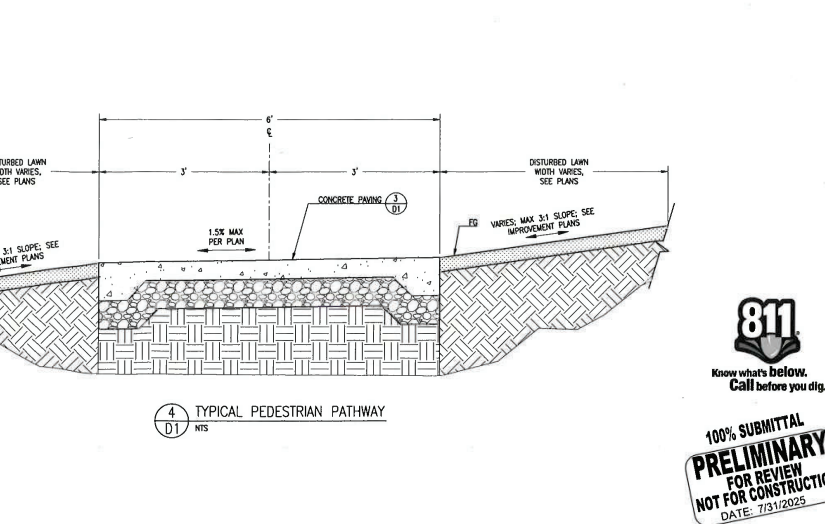
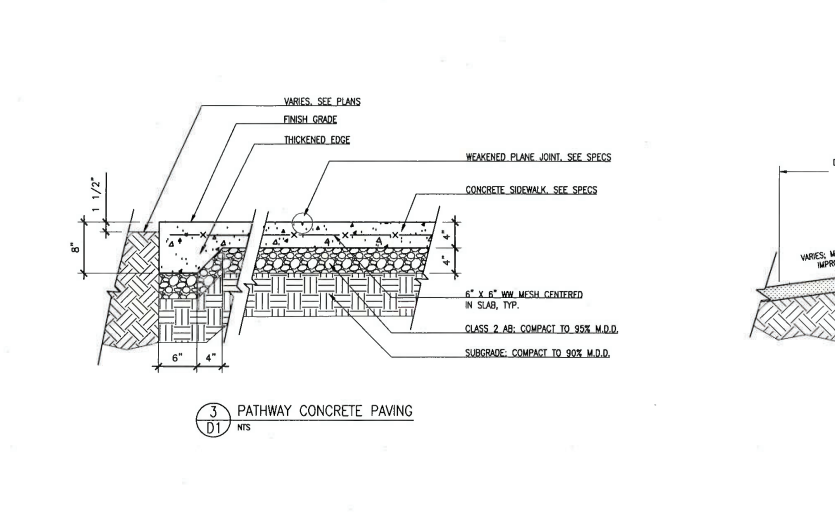

4 TYPICAL PEDESTRIAN PATHWAY
D1 NTS

FILED: 7/31/2025 1:15 PM - Taylor Blvd Sidewalk Installation - Project 484.18.55 - 100% SUBMITTAL PRELIMINARY FOR REVIEW NOT FOR CONSTRUCTION DATE: 7/31/2025



**TAYLOR BLVD
SIDEWALK
INSTALLATION
PROJECT**

OWNER



CITY OF PLEASANT HILL
CITY OF PLEASANT HILL
100 GREGORY LANE
PLEASANT HILL,
CALIFORNIA

NO.	DATE	DESCRIPTION
PROJECT NO:	484.18.55	
DESIGNED BY:	JV	
DRAWN BY:	IMA, AP	
CHECKED BY:	FH	7/21/2025
DATE:	7/31/2025	

This drawing is the property of NCE, including all patented and patentable features, and/or confidential information and its use is conditioned upon the user's agreement not to reproduce the drawing, in whole or part, nor the material contained therein, nor the use of the drawing for any purpose other than specifically permitted in writing by NCE.

SHEET TITLE

CURB RAMP DETAILS

DRAWING
D3

SHEET 11 OF 11

100% SUBMITTAL
PRELIMINARY
FOR REVIEW
NOT FOR CONSTRUCTION
DATE: 7/31/2025

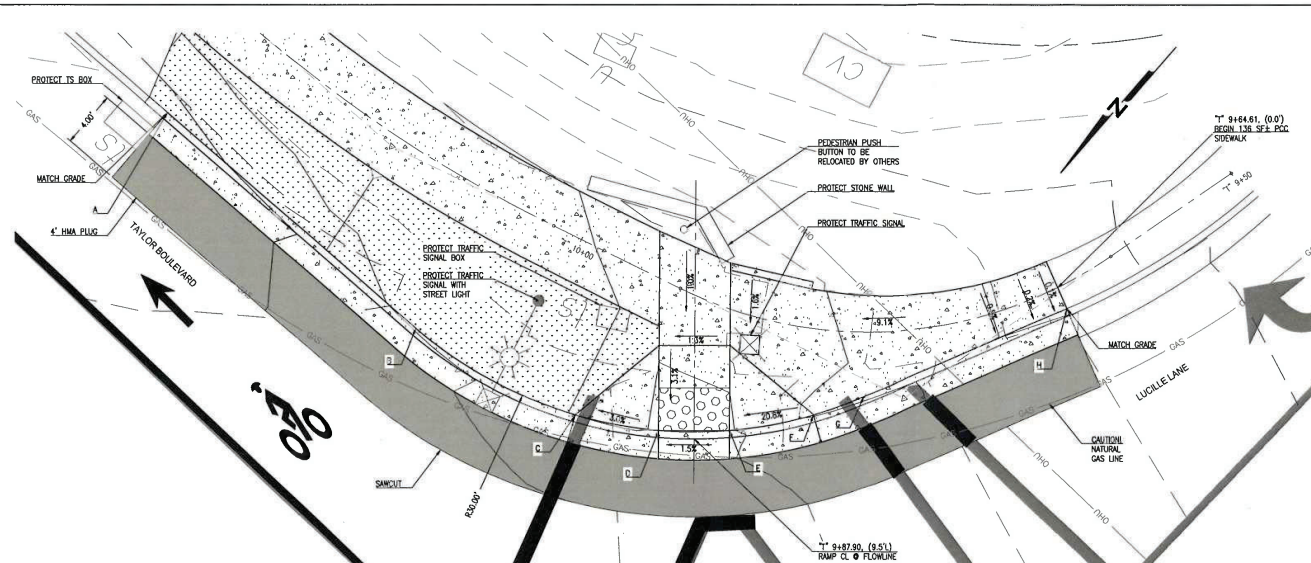

1 TAYLOR BOULEVARD AND LUCILLE LANE CASE A CURB RAMP (SE CORNER)
SCALE: 1"=4'

SE CORNER LUCILLE LANE			
	STA/OFF	TBC EL.	FL EL.
A	T" 10+28.35, (8.5'L)	69.64' (BEGIN)	69.24'
B	T" 10+07.16, (10.8'L)	71.18' (BC)	70.66'
C	T" 9+94.84, (11.3'L)	72.03'	71.45'
D	T" 9+89.84, (9.8'L)	71.84'	71.83'
E	T" 9+86.18, (8.2'L)	71.92'	71.90'
F	T" 9+81.66, (6.1'L)	73.16'	72.39'
G	T" 9+78.66, (4.6'L)	73.41' (EC)	72.70'
H	T" 9+64.69, (1.6'L)	74.44' (END)	73.94'

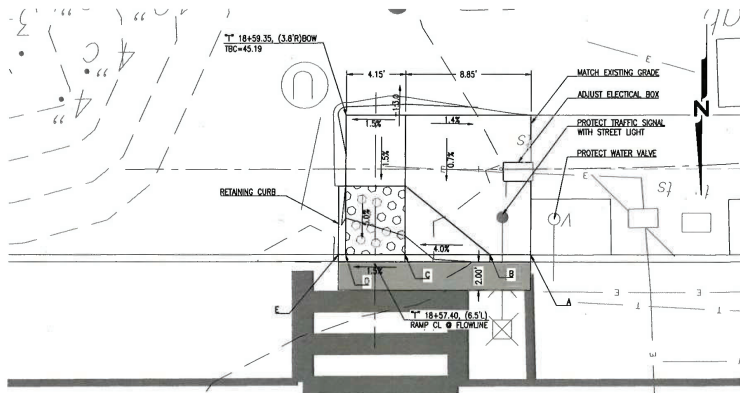

2 TAYLOR BOULEVARD AND CIVIC DRIVE CASE G CURB RAMP (MID BLOCK)
SCALE: 1"=4'

MID BLOCK TAYLOR BLVD			
ID	STA/OFF	TBC EL.	FL EL.
A	T" 18+46.48, (8.0'L)	45.23' (BEGIN)	45.09'
B	T" 18+46.32, (8.0'L)	45.18'	45.02'
C	T" 18+55.32, (8.0'L)	44.39'	44.94'
D	T" 18+59.48, (8.0'L)	44.37'	44.85'
E	T" 18+59.99, (8.0'L)	45.11' (END)	44.82'